

REMOVAL

NOTICE:

- If the wiring connector of the SRS is disconnected with the ignition switch in the ON position, DTCs will be recorded.
 - Never use SRS parts from another vehicle. When replacing the parts, replace them with new ones.
 - Never reuse a seat belt tension sensor if an airbag has previously deployed in a collision.
1. **PRECAUTION (SEE PAGE RS-1 AND RS-3)**
 2. **DISCONNECT CABLE FROM NEGATIVE BATTERY TERMINAL**

Wait for 90 seconds after disconnecting the cable to prevent the airbag working.

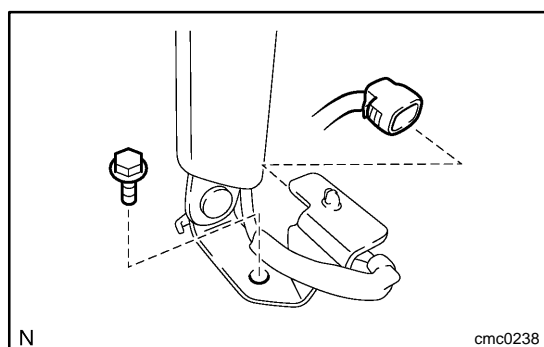

3. **Bench type:**
REMOVE FRONT SEAT OUTER BELT FLOOR ANCHOR RH (SEAT BELT TENSION SENSOR)
 - (a) Disconnect the connector from the seat belt tension sensor.
 - (b) Remove the bolt and the front seat outer belt RH floor anchor.
4. **Split type (Passenger's Side):**
REMOVE SEAT TRACK COVER (SEE PAGE BO-188)
5. **5.Split type (Passenger's Side):**
REMOVE FRONT SEAT ASSEMBLY RH (SEE PAGE BO-188)
6. **Split type (Passenger's Side):**
REMOVE SEAT LEG INNER COVER (SEE PAGE BO-189)
7. **Split type (Passenger's Side):**
REMOVE RECLINING ADJUSTER RELEASE HANDLE (SEE PAGE BO-189)
8. **Split type (Passenger's Side):**
REMOVE RH SEAT CUSHION SHIELD (SEE PAGE BO-189)
9. **Split type (Passenger's Side):**
REMOVE SEAT CUSHION LOWER SHIELD (SEE PAGE BO-189)
10. **Split type (Passenger's Side):**
REMOVE SEATBACK ASSEMBLY (SEE PAGE BO-189)
11. **Split type (Passenger's Side):**
REMOVE SEAT POSITION SENSOR ASSEMBLY (SEE PAGE BO-189)

12. **Split type (Passenger's Side):**
REMOVE RH CENTER SEAT HINGE COVER
(SEE PAGE [BO-189](#))
13. **Split type (Passenger's Side):**
REMOVE RH SEAT CUSHION INNER SHIELD AND SEAT CUSHION COVER (SEE PAGE [BO-189](#))
14. **Split type (Passenger's Side):**
REMOVE SEAT HINGE COVER (SEE PAGE [BO-189](#))
15. **Split type (Passenger's Side):**
REMOVE OUTER SEAT TRACK LOWER FRONT AND REAR BRACKET (SEE PAGE [BO-189](#))
16. **Split type (Passenger's Side):**
REMOVE INNER SEAT TRACK LOWER FRONT AND REAR BRACKET (SEE PAGE [BO-189](#))
17. **Split type (Passenger's Side):**
REMOVE OUTER SEAT TRACK (SEE PAGE [BO-189](#))
18. **Split type (Passenger's Side):**
REMOVE INNER SEAT TRACK (SEE PAGE [BO-189](#))
19. **Split type (Passenger's Side):**
REMOVE SEAT CUSHION FRAME
(SEE PAGE [BO-189](#))

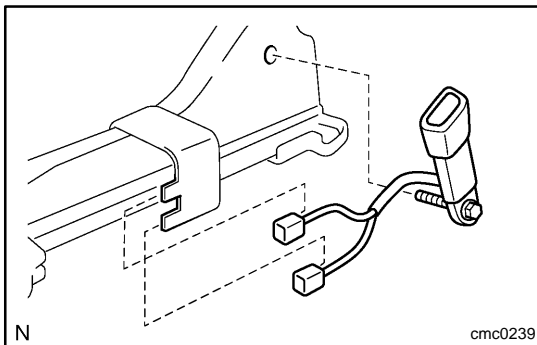

20. **Split type (Passenger's Side):**
REMOVE FRONT SEAT INNER BELT RH (SEAT BELT TENSION SENSOR)
 - (a) Disconnect the 2 connectors from the front seat inner belt RH.
 - (b) Disengage the harness clamps from the seat cushion frame.
 - (c) Remove the bolt and front seat inner belt RH (seat belt tension sensor).